

Line Shaft
with split hubs and servo inserts

optional
laserwelded
optional full stainless
steel version

optional
with carbon tube

DRE

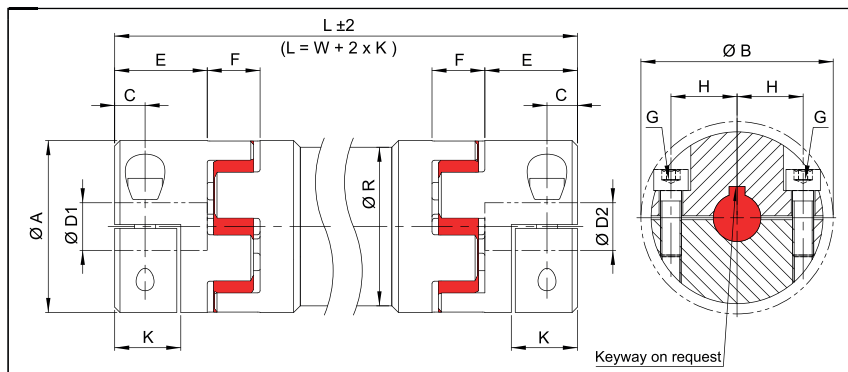

Order Code

DRE / 19 - 2000 - 10 - 16 - 98Sh

Type / Size Length ØD1 (H7) ØD2 (H7) Shore-hardness

Size	Dimensions (mm)												Technical Data		Torque (Nm)			
	Ø D1/D2		Ø A	E	K	F	L		Ø R	Ø B	C	H	G	CT/m (Nm/rad)	64 ShoreD (green)	98 ShoreA (red)	92 ShoreA (yellow)	80 ShoreA (blue)
	min	max					min	max										
9	4	11	20	10	8	10	90	3000	20	23.5	5	7	M2.5 0.85	300	6	5	3	1.8
12	4	12	25	11	8	12	95	3000	25	27.2	5	9	M3 2	550	12	9	5	3
14	4	16	30	11	8	13	102	3000	30	34	5	10.5	M4 5	500	16	12.5	7.5	4
19	8	21/25*	40	25	19.5	16	133	3000	35	46	8.0	14.5	M6 15	1770	26	21	12	6
24	10	32	55	30	22.0	18	157	3000	50	57.5	10.5	20	M6 15	6400	75	60	35	17
28	14	37	65	35	25.0	20	181	3000	60	73	11.5	25	M8 40	11400	200	160	95	46
38	18	48	80	45	33.0	24	229	3000	75	83.5	15.5	29	M8 40	23000	405	325	190	x
42	22	50	95	50	36.5	26	253	3000	100	93.5	18.0	32	M10 84	194000	560	450	265	x
48	22	57	105	56	39.5	28	281	3000	100	105	18.5	36	M12 145	194000	655	525	310	x

Size	Transmittable torque (Nm) depending on shaft diameter (mm)																								
	4	6	8	10	14	15	16	18	19	20	22	24	25	28	30	32	35	38	40	42	45	46	48	50	55
9	2.6	3.9	5.2	6.5																					
12	5.8	8.7	11.7	14.6	20.4	21.8	23.3																		
14	10.3	15.5	20.7	25.8	36.1	38.7	41.3																		
19			47	59	83	89	95	107	113	119															
24				59	83	89	95	107	113	119	130	142	148	166	178	190									
28					123	132	141	159	167	176	194	211	220	247	264	282	308	335							
38								159	167	176	194	211	220	247	264	282	308	335	352	370	396				
42											370	404	420	471	505	538	589	639	673	706	757	774	807	841	
48											539	588	612	686	735	784	857	931	980	1029	1102	1127	1176	1225	1347

Material

hub: aluminium
spider element: polyurethane
tube: aluminium

Hub

bore tolerance: H7

Keyway

optional acc. DIN 6885

* Hubs for bores > 21H7 to 25H7 will be supplied with 2 x M4 screws. Longer versions up to 6m on request!
Information about permissible misalignments and maximum speeds are available in our assembly - instructions.
Further spider elements and technical data are available on page 44 and 45.
All series are available with loose-fit spiders (see page 45).